

# MESOZOIC ROCKS OF SOUTHERN ARIZONA AND ADJACENT AREAS

Edited by William R. Dickinson and Margaret A. Klute

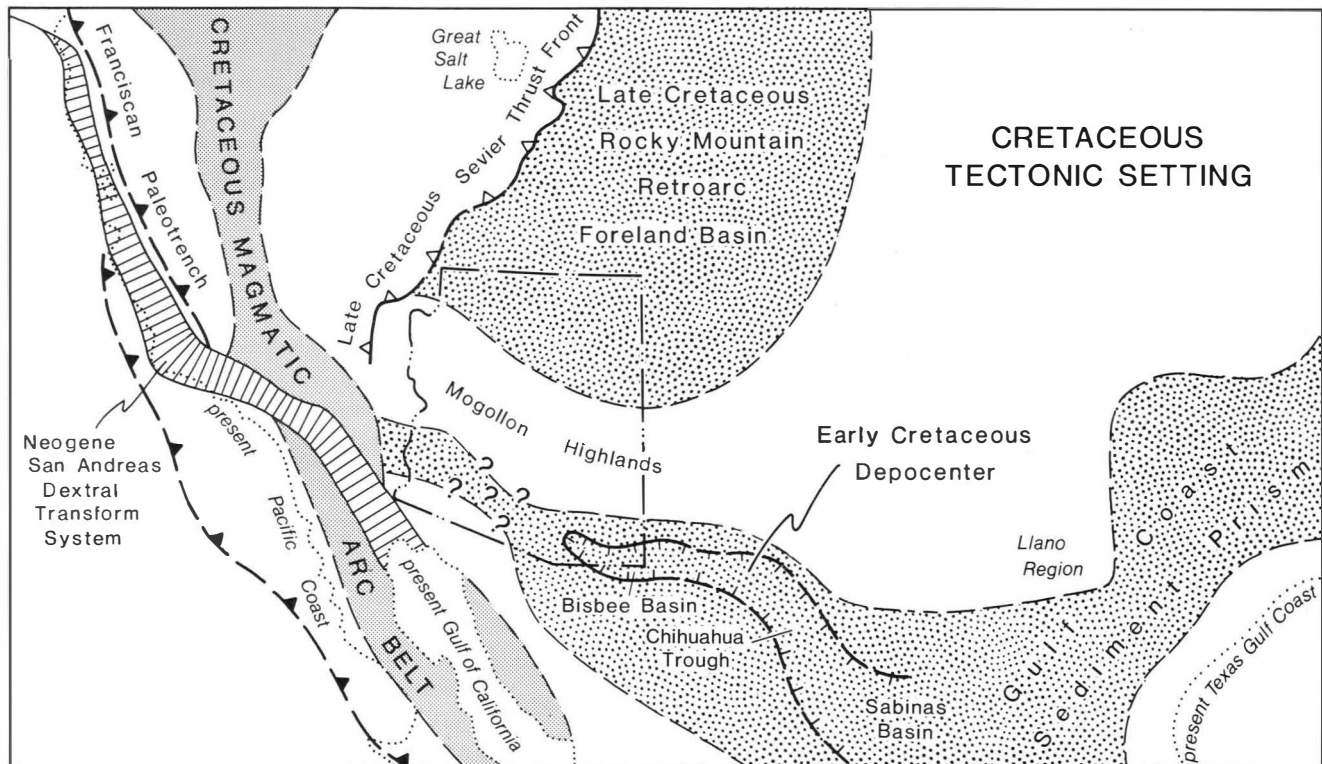

ARIZONA GEOLOGICAL SOCIETY DIGEST VOLUME 18

Tucson, Arizona

1987

**THIS PAGE  
INTENTIONALLY BLANK**

# MESOZOIC ROCKS OF SOUTHERN ARIZONA AND ADJACENT AREAS

Edited by William R. Dickinson and Margaret A. Klute

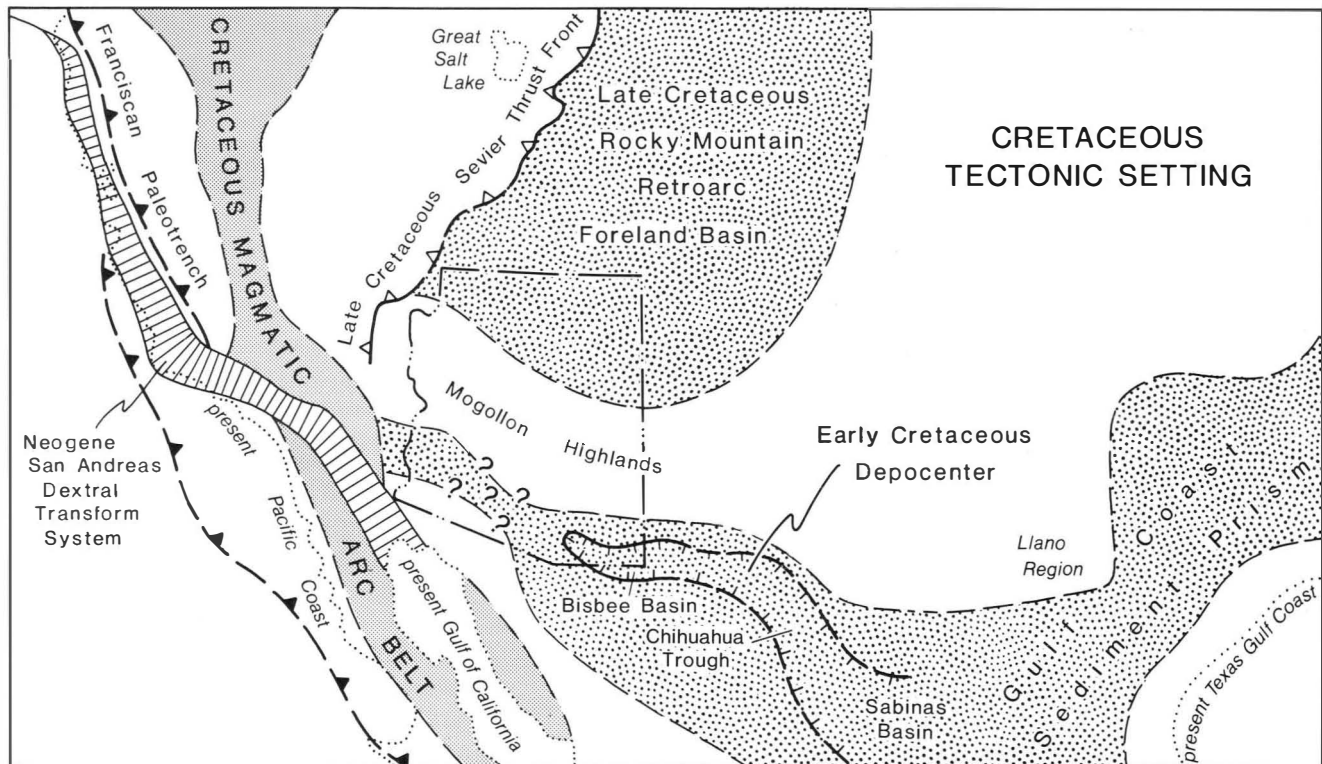

ARIZONA GEOLOGICAL SOCIETY DIGEST VOLUME 18

Tucson, Arizona

1987

## ACKNOWLEDGMENTS

The editors appreciate the encouragement and guidance of the Publications Committee of the Arizona Geological Society, the cooperation of authors for timely preparation of manuscripts, the help of Rick Brokaw of Serious Design in preparing and repairing key figures, and the expert technical support of Jo Ann Overs, who produced camera-ready copy for about half the papers in this volume using word-processing facilities of the Department of Geosciences at the University of Arizona. The editors also acknowledge research support for work on the Cordilleran-Caribbean Connection from National Science Foundation Grant EAR-8417016.

## ARIZONA GEOLOGICAL SOCIETY OFFICERS

President ..... Jim Briscoe  
Vice President ..... John Guilbert  
Treasurer ..... John Latta  
Secretary ..... Erick Weiland  
Assistant Secretary ..... Mike Sheets

### Councillors

Dick Ahern  
Eric Lauritsen  
Jim Sell  
Chris Eastoe  
Steve Reynolds  
Joe Wilkins

Address to order this or other AGS publications:

Arizona Geological Society Publications  
P.O. Box 40952  
Tucson, Arizona 85717

## FOREWORD

Over the past decade or so, a wealth of new information has been gathered in the field and in the laboratory about the Mesozoic rocks of southern Arizona and adjacent areas of California, Sonora, New Mexico, and Chihuahua. Research groups from the U.S. Geological Survey, the University of Arizona, and several other universities on both sides of the international border have all been active in the effort to understand Mesozoic relations better. The new data have led some workers to postulate significant new interpretations about the Mesozoic geologic history of the region.

Publication of this volume reflects the desire of the officers and members of the Arizona Geological Society to make as much of this new knowledge as possible available to geoscientists everywhere in concise and convenient format. However, no papers published previously in standard journals or other series are repeated here. The contents of the contributions are otherwise accessible only in widely scattered theses and dissertations of unwieldy size, or else are buried in files not accessible at all to the profession at large.

It is a truism that no progress is ever made in geology without standing on the shoulders of those who have gone before. In the present instance, most authors of this volume owe a clear debt to previous pioneering work on the Mesozoic of southeastern Arizona. Without slighting anyone else, we call special attention to the seminal work, lovingly pursued and patiently assembled, of Philip T. Hayes and Harald Drewes. Their maps and publications, cited repeatedly in this volume, constitute a valued resource for all who entered the lists later. Although some papers herein challenge specific conclusions that they or their coworkers have reached, the reader should never lose sight of the fact that the central body of their synthesis remains intact as a valid point of departure for all future workers in the region.

Because little current research is underway on porphyry copper systems, the Laramide episode of latest Mesozoic and earliest Cenozoic time does not command the space in this volume that it might be thought to deserve from its inherent importance. For recent interpretations of Laramide geology in southern Arizona, interested readers are referred to the 1982 book, "Advances in Geology of the Porphyry Copper Deposits, Southwestern North America," edited by Spencer R. Titley and published by the University of Arizona Press.

Other pertinent information on the Mesozoic geology of southern Arizona and adjacent areas is included in the following special volumes published during the last decade:

(a) "Land of Cochise, Southeastern Arizona," the guidebook for the twenty-ninth annual field conference of the New

Mexico Geological Society in 1978 (edited by J.F. Callender, J.C. Wilt, and R.E. Clemons);

(b) "Geology of Northern Sonora," the guidebook for field trip #27 of the 1979 annual meeting of the Geological Society of America in San Diego (edited by Thomas H. Anderson and Jaimie Roldan-Quintana and published jointly by the Instituto de Geologia of the Universidad Nacional Autonoma de Mexico in Hermosillo, Sonora, and by the University of Pittsburgh);

(c) "Studies in Western Arizona," Volume XII of the Arizona Geological Society Digest published in 1980 (edited by Judith P. Jenney and Claudia Stone);

(d) "Mesozoic-Cenozoic Tectonic Evolution of the Colorado River Region, California, Arizona, and Nevada" (the Anderson-Hamilton Volume edited by E.G. Frost and D.L. Martin for Cordilleran Publishers in conjunction with the 1982 meeting of the Cordilleran Section of the Geological Society of America in San Diego);

(e) "Geology and Mineral Resources of North-Central Chihuahua," the guidebook for the 1983 field conference of the El Paso Geological Society (edited by K.F. Clark and P.C. Goodell);

(f) "Frontiers in Geology and Ore Deposits of Arizona and the Southwest," Volume XVI of the Arizona Geological Society Digest published in 1986 (edited by Barbara Beatty and P.A.K. Wilkinson).

Critical investigations of Mesozoic age relationships using several methods of isotopic geochronology are currently underway at several laboratories using rock samples collected within the region treated here. As most of this work was still at an incomplete stage when this volume went to press, few of its fruits could be included. Results expected soon should resolve some of the issues raised by authors of this volume, and will probably also raise new questions not previously suspected.

We hope that geoscientists will see this volume as just one step on the path to better understanding of Mesozoic geology in southern Arizona, and will take the conclusions of its authors as a stimulus to further work leading to yet more definitive interpretations.

W.R.D. and M.A.K.

## TABLE OF CONTENTS

	<u>Page</u>
Acknowledgments .....	ii
Foreword .....	iii
Table of Contents .....	iv
Geographic Index Map .....	vi
<b>Southeastern California</b>	
Permian to Middle Triassic Rocks of the Mojave Desert .....	1
J. Douglas Walker	
Mesozoic Tectonic and Magmatic History of the Central Mojave Desert .....	15
C.R. Karish, E.L. Miller, and J.F. Sutter	
Mesozoic Geology and Tectonics of the Big Maria Mountains Region, Southeastern California .....	33
Warren Hamilton	
Geochemistry of the Orocopia Schist, Southeastern California: Summary .....	49
Gordon B. Haxel, James R. Budahn, Terry L. Fries, Bi-Shia W. King, Lloyd D. White, and Phillip J. Aruscavage	
<b>Southwestern Arizona</b>	
Stratigraphy and U-Th-Pb Geochronology of Triassic and Jurassic Rocks in West-Central Arizona .....	65
Stephen J. Reynolds, Jon E. Spencer, and Ed DeWitt	
Structure and Stratigraphy of Mesozoic Sedimentary and Volcanic Rocks in the New Water Mountains, Southwestern Arizona .....	81
David R. Sherrod and Richard D. Koch	
Mesozoic Stratigraphy of the Granite Wash Mountains, West-Central Arizona .....	91
Stephen E. Laubach, Stephen J. Reynolds, and Jon E. Spencer	
Mesozoic Stratigraphy of the Little Harquahala and Harquahala Mountains, West-Central Arizona .....	101
Stephen M. Richard, Stephen J. Reynolds, and Jon E. Spencer	
<b>Southeastern Arizona and Northern Sonora</b>	
<b><u>Canelo Hills Volcanics</u></b>	
Paleomagnetism of the Jurassic Canelo Hills Volcanics, Southeastern Arizona .....	121
Steven R. May and Robert F. Butler	
Geochemistry of the Canelo Hills Volcanics and Implications for the Jurassic Tectonic Setting of Southeastern Arizona .....	139
C.K. Krebs and Joaquin Ruiz	
<b><u>Stratigraphy and Structure</u></b>	
Geology of the Planchas de Plata Area, Northern Sonora, Mexico .....	153
Lawrence Segerstrom	
Stratigraphy, Structure, and Geochemistry of Mesozoic Rocks in the Pajarito Mountains, Santa Cruz County, Arizona .....	165
Nancy Riggs	

## TABLE OF CONTENTS (continued)

	<u>Page</u>
Tectonic Implications of Stratigraphy and Structure of Cretaceous Rocks and Overlying Mid-Tertiary Cover in Hot Springs Canyon, Galiuro Mountains, Southeastern Arizona .....	177
Thomas C. Goodlin and Roger A. Mark	
Mesozoic and Early Tertiary Structural History of the Geesaman Wash Area, Northeastern Catalina-Rincon Metamorphic Core Complex .....	189
Susanne U. Janecke	
 <b><u>Clastic Sedimentology</u></b>	
Stratigraphy and Paleogeography of Lower Cretaceous Rocks, Sierra El Chanate, Northwest Sonora, Mexico .....	203
César Jacques-Ayala and Paul Edwin Potter	
Sedimentation and Stratigraphy of the Lower Cretaceous Amole Arkose, Tucson Mountains, Arizona .....	215
Rob Risley	
Regional Stratigraphic, Sedimentologic, and Tectonic Relationships of the Glance Conglomerate in Southeastern Arizona .....	229
William L. Bilodeau, Charles F. Kluth, and Laurel K. Vedder	
Petrofacies of Morita Formation (Bisbee Group), Southeastern Arizona and Northern Sonora, Mexico .....	257
Kermit Jamison	
Tectonic Significance of Sandstone Petrofacies Within the Bisbee Basin of Southeastern Arizona .....	263
Margaret A. Klute	
Stratigraphy and Sedimentology of the Bisbee Group in the Whetstone Mountains, Southeastern Arizona .....	273
Lawrence E. Archibald	
Cretaceous Sedimentary Geology of the Rucker Canyon Area, Cochise County, Arizona .....	283
F. Alan Lindberg	
Depositional Environments and Sandstone Petrography of Cretaceous Sedimentary Rocks, Adobe Canyon, Santa Rita Mountains, Southeastern Arizona .....	301
Kerry F. Inman	
Depositional History of Upper Cretaceous Fort Crittenden Formation in Southeastern Arizona .....	315
Michael J. Hayes	
 <b><u>Carbonate Sedimentology</u></b>	
Stratigraphy and Correlation of the Cretaceous Mural Limestone, Arizona and Sonora .....	327
Robert W. Scott	
Revised Stratigraphy of the Mural Limestone: A Lower Cretaceous Carbonate Shelf in Arizona and Sonora .....	335
E. Robert Warzeski	
Bisbee Group (Lower Cretaceous) Carbonates, Guadalupe Canyon Area, Southeastern Arizona .....	365
Robert C. Ferguson	
<b>Southwestern New Mexico and Northern Chihuahua</b>	
Tectonic, Eustatic, and Climatic Control on Cretaceous (Aptian to Turonian) Sedimentation in Southwestern New Mexico .....	371
Greg H. Mack	
Mesozoic Geology of Northwestern Chihuahua, Mexico .....	381
M.L. Brown and R. Dyer	

# GEOGRAPHIC INDEX TO PAPERS

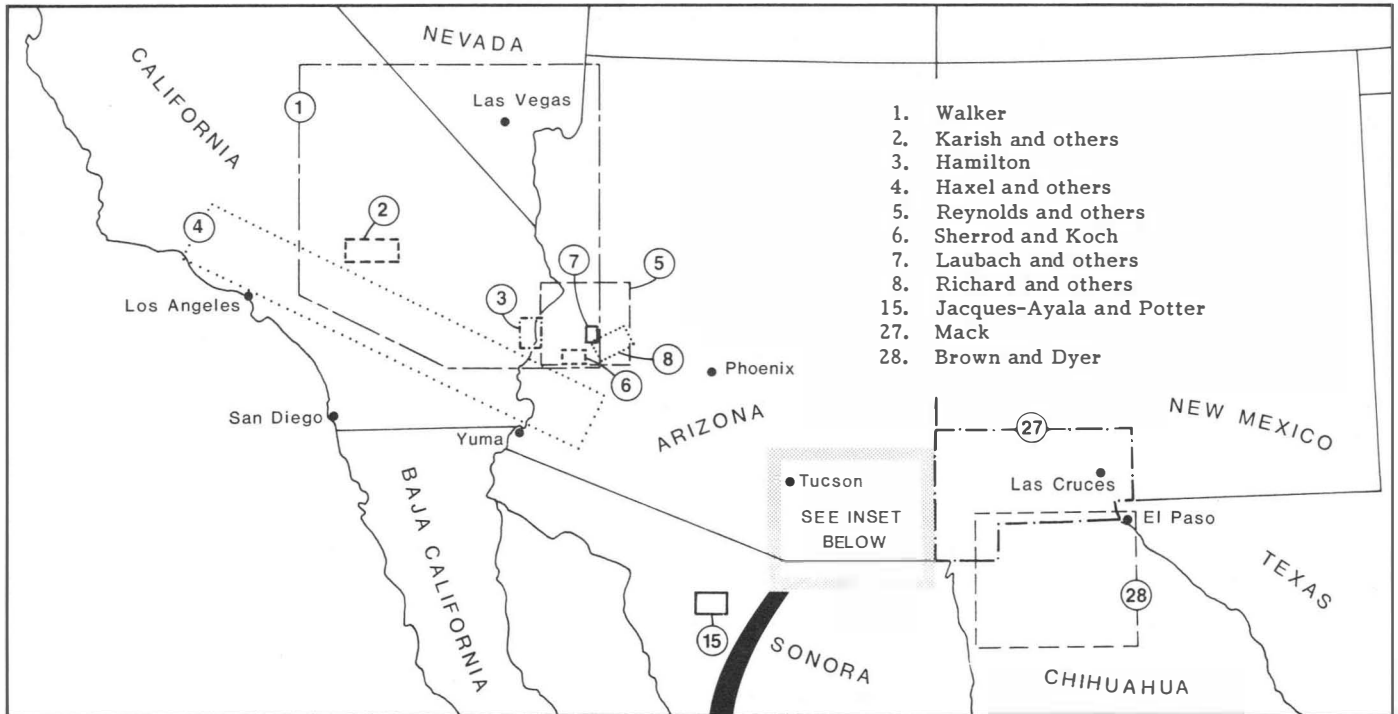

1. Walker
2. Karish and others
3. Hamilton
4. Haxel and others
5. Reynolds and others
6. Sherrod and Koch
7. Laubach and others
8. Richard and others
15. Jacques-Ayala and Potter
27. Mack
28. Brown and Dyer

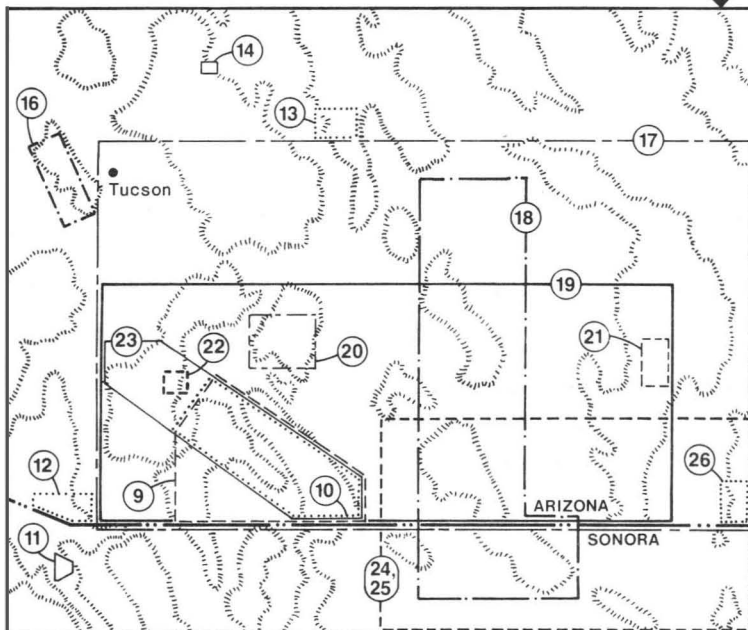

9. May and Butler
10. Krebs and Ruiz
11. Segerstrom
12. Riggs
13. Goodlin and Mark
14. Janecke
16. Risley
17. Bilodeau and others
18. Jamison
19. Klute
20. Archibald
21. Lindberg
22. Inman
23. Hayes
24. Scott
25. Warzeski
26. Ferguson